

Structure principale

- I.N de 30/10 mm
- Cornière de 50 mm
- Palier droit 20629
- Cornière de 30

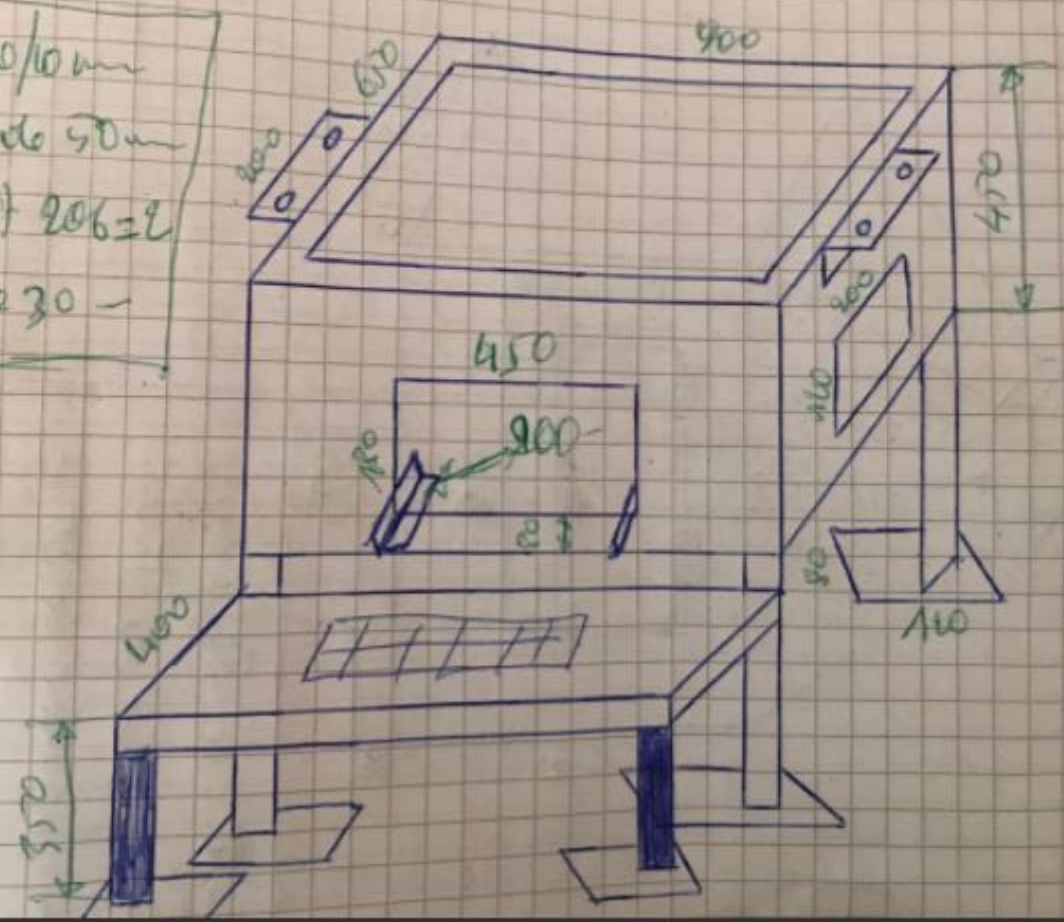

- T.N de 4mm
- T.R de 25
- Roulement 206

Mixeur manuel
 en fer plat de 4mm

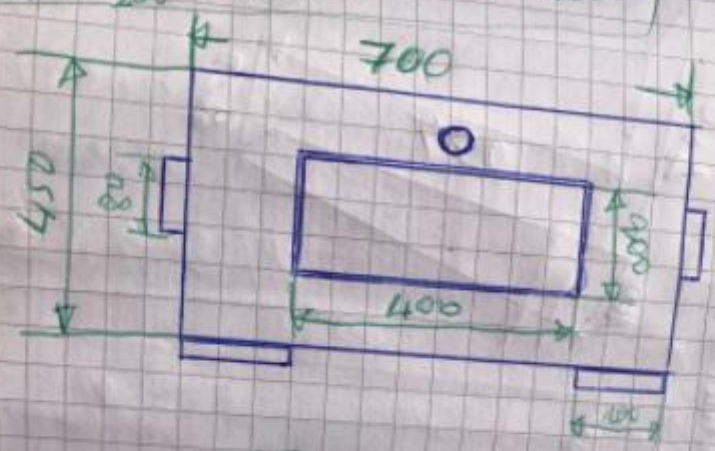

Mixeur

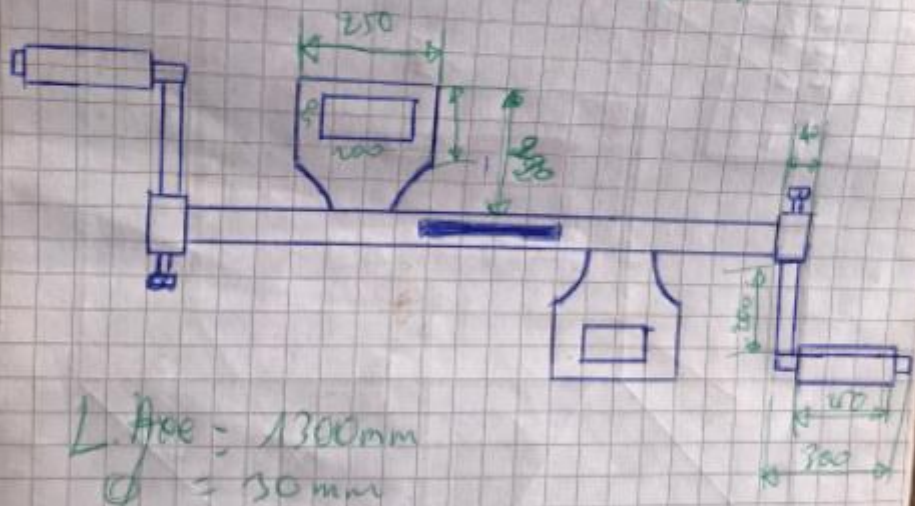

L'axe = 1300mm
 $\phi = 30$ mm

Motapeur

- T.N de 4mm
- fer rond épaisseur de 30
- T.R de 25 x 30
- base de 60 x 30

Plan de Cône

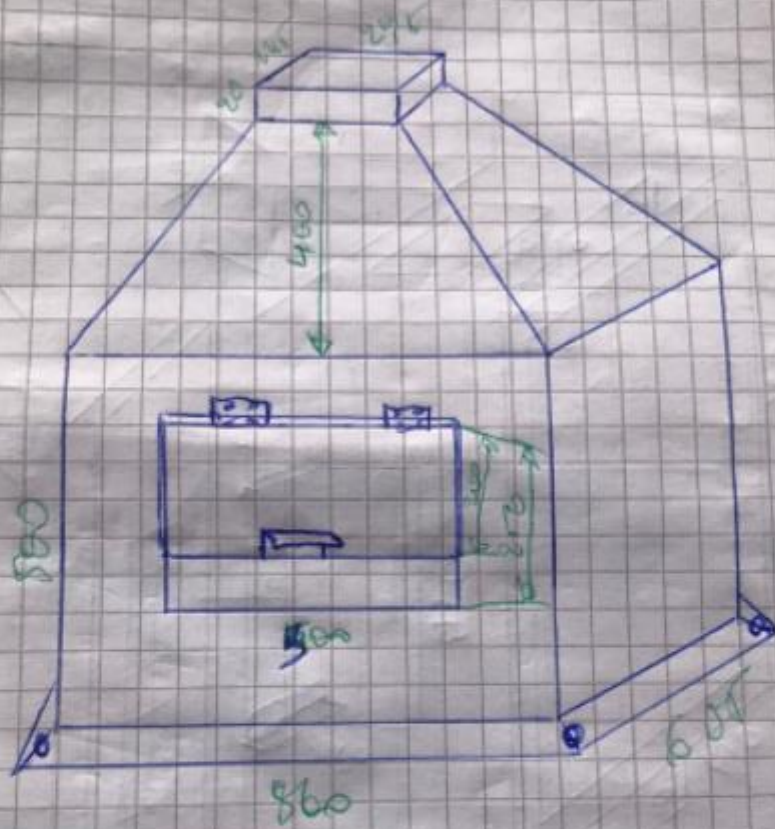

- T.N de 30/10 mm
- Cornière de 30 mm
- Channière de 80 mm
- Channière de 50 mm

Mixeur manuel

pour plat de 40cm

- N de la machine
- T.R. de 2.5 mm
- Roulement 306

Tambour

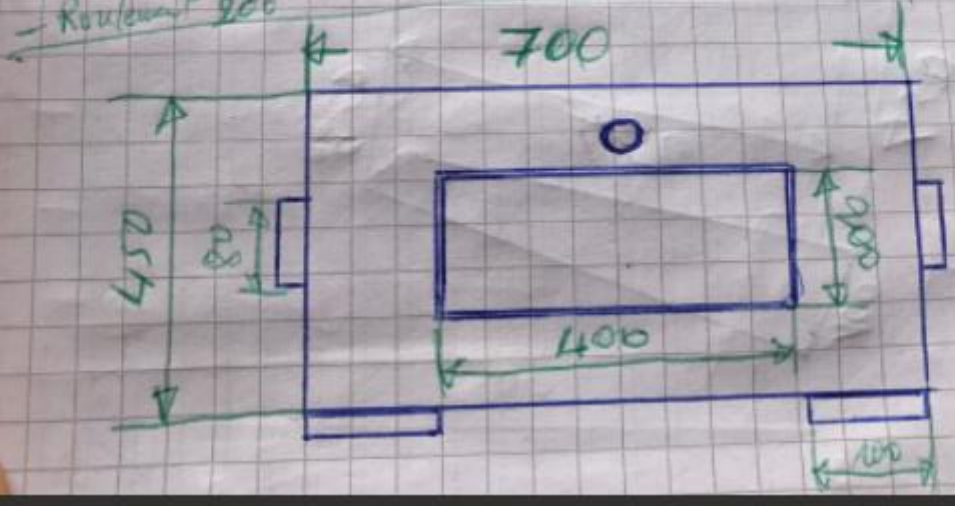

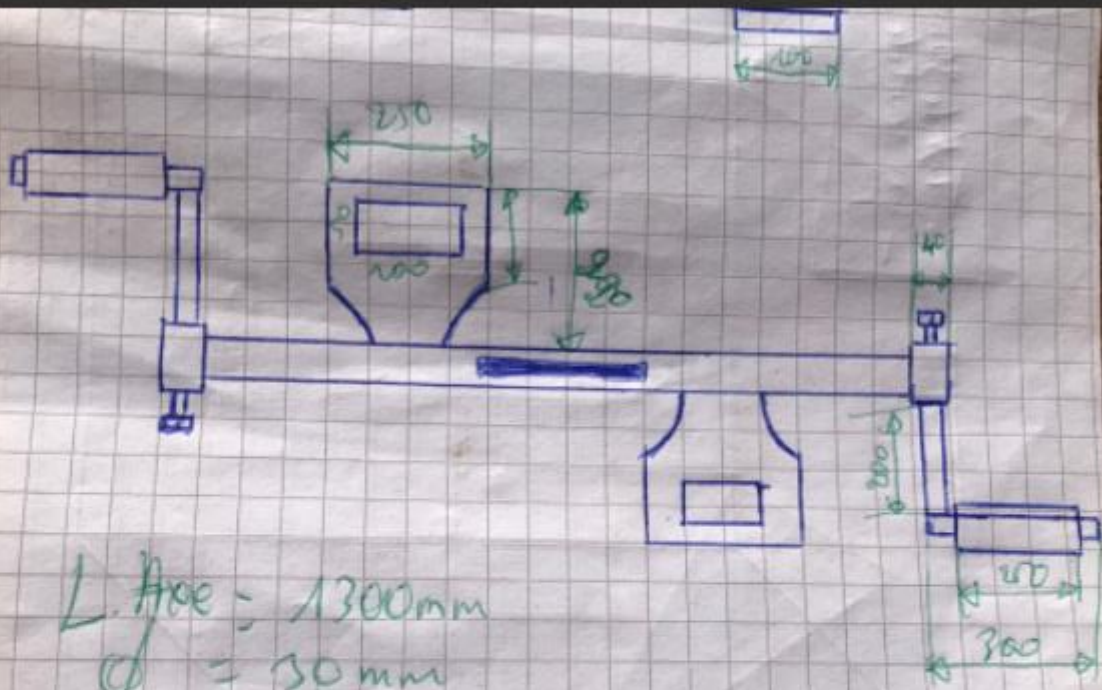

L. Axe = 1300 mm
 $\phi = 30$ mm

Malavener

- T.N de 4 mm
- fer rond classe de 30
- T.R de 25 x 30
- bague de ϕ int 30

Bac de déversement

- T.N de 30 mm
- per rond de 10 mm

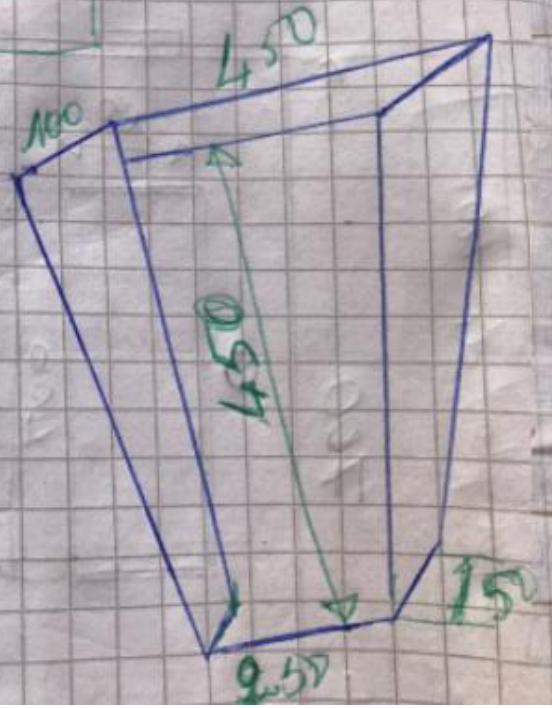

Plan de Cône

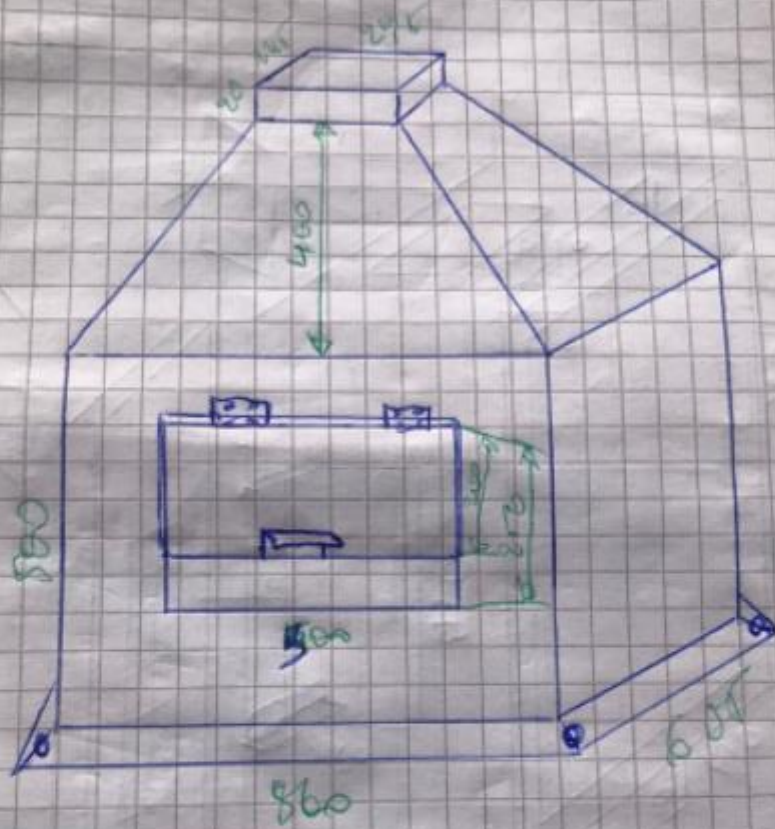

- T.N de 30/10 mm
- Cornière de 30 mm
- Channière de 80 mm
- Channière de 50 mm

Chambre de 80
chambre de 40

Chemineé

- T.N de 10/10 m
- Cornière 30 mm
- Fer plat 30 x 10 mm

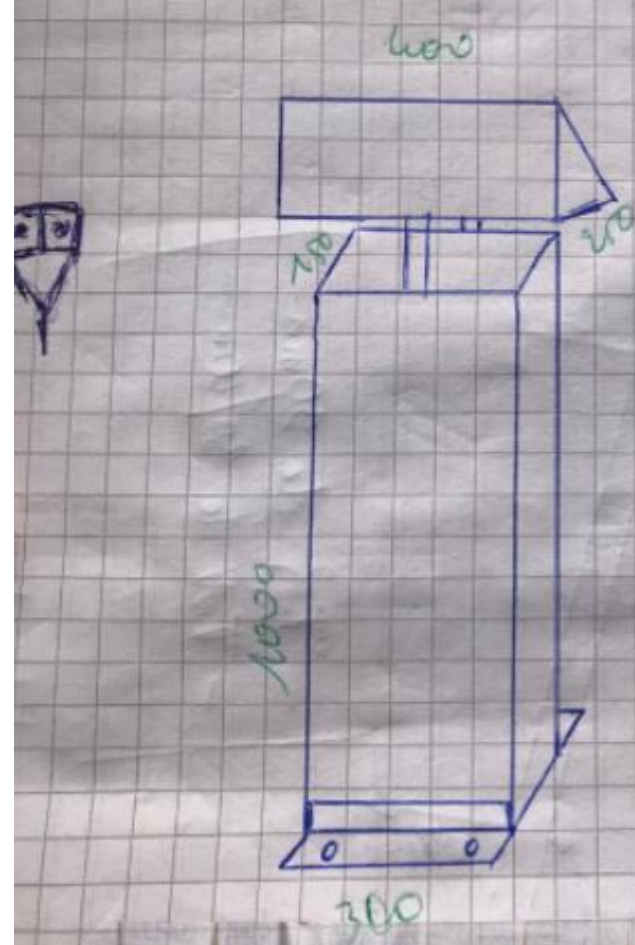

Spatula

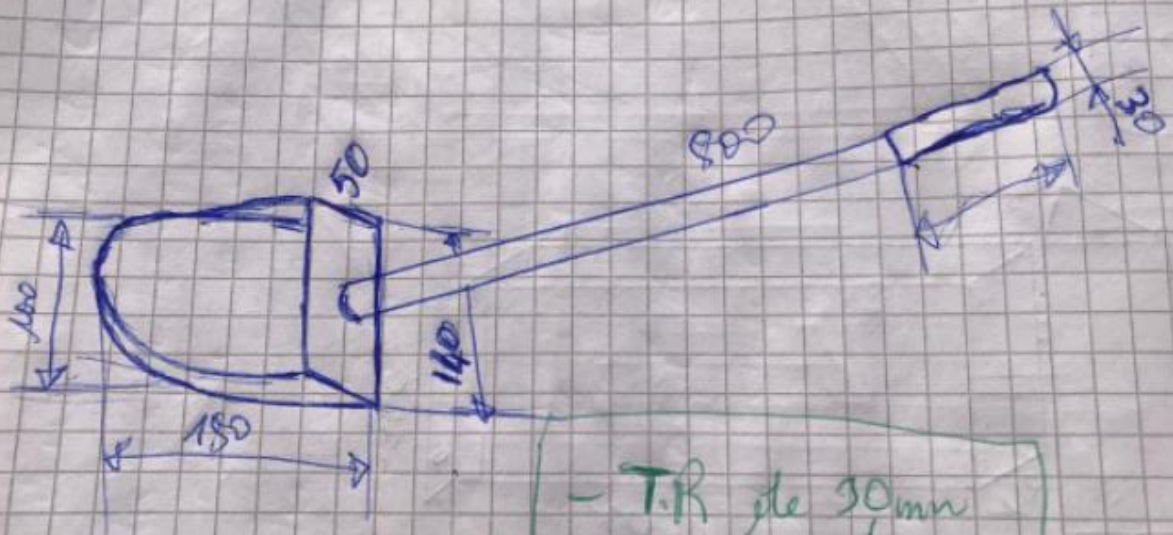

- T.R de 30mm
- T.N de 80/10mm